

52.652

Viewmate monitor arm - desk 652

The proximity of the monitor and pole makes this is an ideal, compact POS (Point Of Sale) solution. Easily set the height of your monitor with the clamp lever. An ergonomic design that is robust, cost-effective and easy to use.

- Static height adjustment range of 295 mm (11,6")
- Fixed depth
- Main components made of steel
- VESA MIS-D 75 x 75/100 x 100 mm compatible
- Monitor: tilt +90°/-90°, swivel +90°/-90°, rotate 360°
- Weight capacity max. 15 kg (33 lb) per monitor
- Comes with a desk clamp mount and bolt-through desk mount
- Suitable for a desktop thickness of 5 up to 40 mm (0,2" - 1,6") (clamp) or 50 mm (2,0") (bolt through)
- Monitor size limit: height 713 mm (28,1")
- Easy to adjust in height using the clamp lever

viewmate ^x

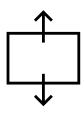
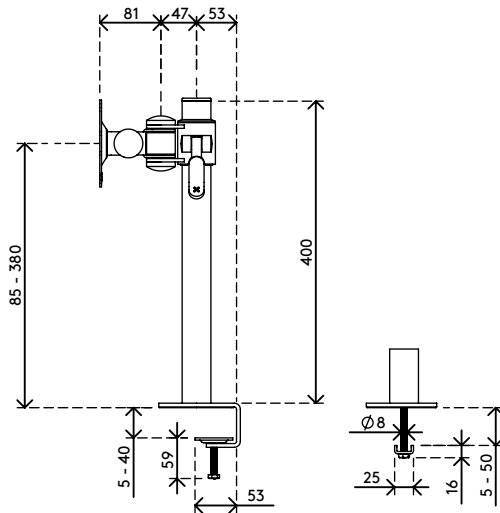
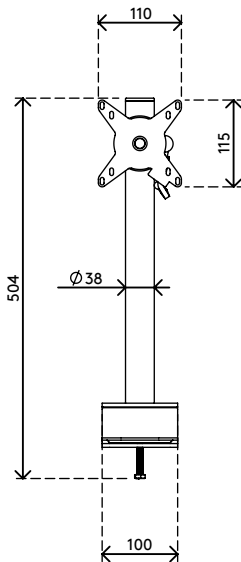
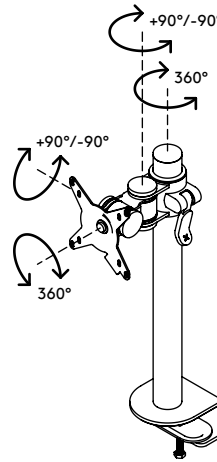
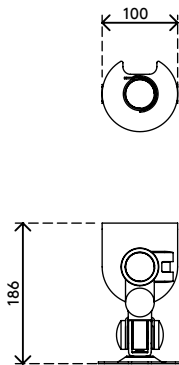

295 mm (11,6")



+90°/-90°

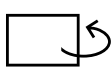

+90°/-90°



360°



713 mm (28,1")



75 x 75/100 x 100



15 kg (33 lb)

Viewmate monitor arm - desk 652

2020/10/06

52.652

530 x 170 x 106 mm

1 pcs

silver

3,6 kg

805410526528